

# Ribbed Tile Pan

## INSTALLATION GUIDE

The following guidelines are provided to insure proper installation of Ribbed Tile Pan, however local building codes may differ so please consult with the local building department for any different or additional installation requirements.

The Ribbed Tile Pan flashing is used at a side wall abutment to channel down the roof. Incorporated with the Ribbed Tile Pan flashing a kick-out flashing is required. Kick-out flashings hang over the edge of the roof to divert water away from the adjacent wall or around any obstacles that the roof may butt into. The kick-out flashing should be installed prior to the Ribbed Tile Pan flashing above the rain gutter and/or drip edge flashing.

### INSTALLATION

The following steps are provided for easy applications of the kick-out flashings and Ribbed Tile Pan.

1. Roofing underlayment must be applied in a shingle fashion turned up the vertical wall abutment minimum 4".
2. Bend Kick-out flashing at a 90° in middle of a 12"x12" minimum 26 gauge G90 metal. (Figure 1)
3. Make the first 6" cut straight towards the 90° bend. Make a second 6" cut above the first cut at a 40°. (Figure 2)
4. Fold the straight cut under the 40° cut to create an 180° bend. The Kick-out flashing should be sealed or soldered at lapping joint. (Figure 2)
5. Install a separate piece of flat stock 26 gauge G90 metal or construction grade house wrap material in shingle fashion between the wall and Kick-out flashing. (Figure 3)
6. Starting at the bottom of the roof, position Kick-out flashing at wall abutment over the underlayment and against the house wrap allowing Kick-out piece to overhang the drip edge min 1" so that water is able to be diverted away from the adjoining wall abutment. (Figure 3)
7. Seal any opening at transition between wall and Kick-out flashing. (Figure 4)

Figure 1

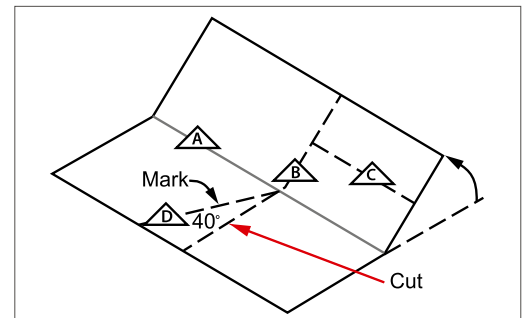

Figure 2

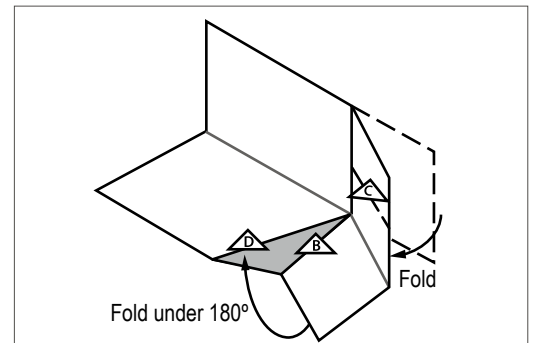

Figure 3

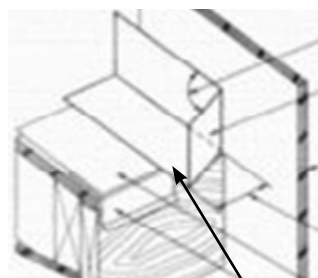
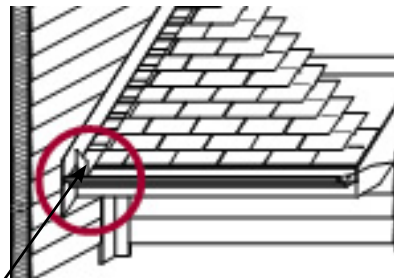

Figure 4



Kick-out flashing

8. Installed Ribbed Tile Pan Flashing at wall abutment over the underlayment overlapping the top of the kick-out flashing, min 4". (Figure 5)
9. Where a side wall abutment joins a head-wall, cut Ribbed Tile Pan flashing equal length of side wall abutment plus adequate length to provide the Ribbed Tile Pan Flashing to site on top of the head wall flashing and onto the row of roof tile below minimum 4". (Figure 6)
10. Is optional, a transition allowing the Ribbed Tile Pan flashing to pass through the eave riser/bird stops metal flashing by cutting a relief cut of sufficient size into the eave riser/bird stops metal flashing. (Figure 7)
11. For a traditional clay S/two piece tile, a 2x nailer board may be fastened on top of the underlayment next to the Ribbed Tile Pan Flashing to support the barrel section of the clay roof tile. (Figure 8)
12. Where required by local code: Horizontal battens should be applied on top of the underlayment and on top of Ribbed Tile Pan. (Figure 9)
13. Fastening Ribbed Tile Pan flashing to the vertical wall abutment wood framing with a standard galvanized roofing nail maximum 2" from the top edge of the Ribbed Tile Pan flashing.

Figure 5

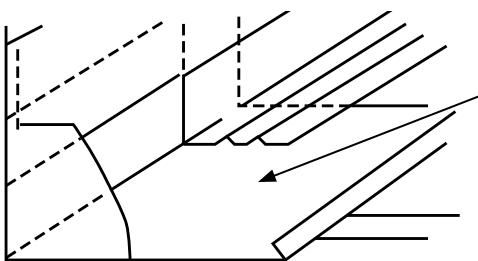

**Ribbed Tile Pan Flashing overlapping Kick-out Flashing**

Figure 6

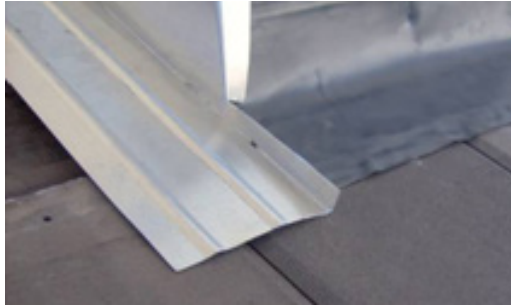

Figure 7

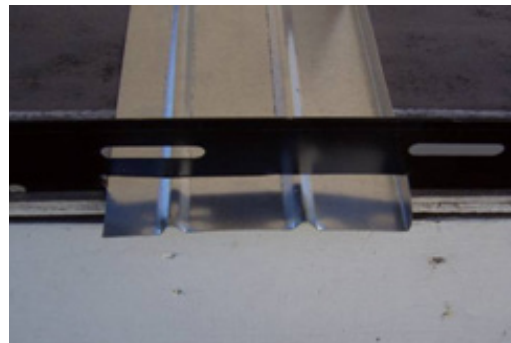

Figure 8

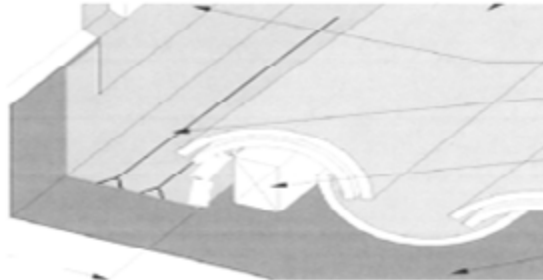

Figure 9

